

ROB MCKENNA

Introduced by: Brian Derdowski

July 1, 1997
ddes/jk

Proposed No.: 97-456

ORDINANCE NO. **12882**

AN ORDINANCE related to road redesignation;
changing the name of 212th Avenue Southeast to
"Peregrine Point Way Southeast".

PREAMBLE:

This roadway is designated as 212th Avenue Southeast. There is another roadway designated as 212th Avenue Southeast to the north and another roadway designated as 212th Way Southeast which also accesses onto East Lake Sammamish Parkway Southeast. This has caused great confusion in locating homes on all three roads. Application has been received from nine property owners, constituting ninety percent of those property owners whose addresses would be affected, requesting renaming of the entire roadway to "Peregrine Point Way".

BE IT ORDAINED BY THE COUNCIL OF KING COUNTY:

SECTION 1. The roadway designated as "212th Avenue Southeast" described as commencing in a northerly direction from East Lake Sammamish Parkway Southeast and in the east half of Section 17, Township 24 North, Range 6 East, W.M. legal described on Attachment A to this ordinance and shown on Attachment B to this ordinance, is hereby redesignated in its entirety as "Peregrine Point Way Southeast".

SECTION 2. The 20-day notice requirement for affected property owners in Ordinance 10915, Section 2 shall be met.

1
2
3
4
5
6
7
8
9
10
11
12
13
14
15
16
17
18
19
20
21
22
23
24
25
26
27
28
29
30

SECTION 3. The director of the department of transportation shall accomplish any necessary sign changes within sixty days of the effective date of this ordinance.

SECTION 4. The director of the department of development and environmental services shall accomplish any necessary address change notifications within ninety days of the effective date of this ordinance.

INTRODUCED AND READ for the first time this 21st day of July, 1997.

PASSED by a vote of 12 to 0 this 29th day of September, 1997.

KING COUNTY COUNCIL
KING COUNTY, WASHINGTON

Jane Hayes
Chair

ATTEST:

Theresa
Clerk of the Council

APPROVED this 9 day of October, 1997.

Donald Amis
King County Executive

Attachments:
A. Legal description
B. Map

12882

ATTACHMENT A

PEREGRINE POINT WAY SOUTHEAST
ABBREVIATED LEGAL DESCRIPTION

The following described portion of roadway is hereby redesignated as **Peregrine Point Way Southeast**.

212th Avenue Southeast, beginning approximately 140 feet westerly of the east section line of Section 17, Township 24 North, Range 6 East W.M. and on the northerly boundary of East Lake Sammamish Parkway Southeast, and continuing in a generally northeasterly, northerly and northwesterly direction to its terminus with Southeast 40th Place.

12882

ATTACHMENT B
212TH AVENUE SOUTHEAST
Road Name Change to
PEREGRINE POINT WAY SOUTHEAST

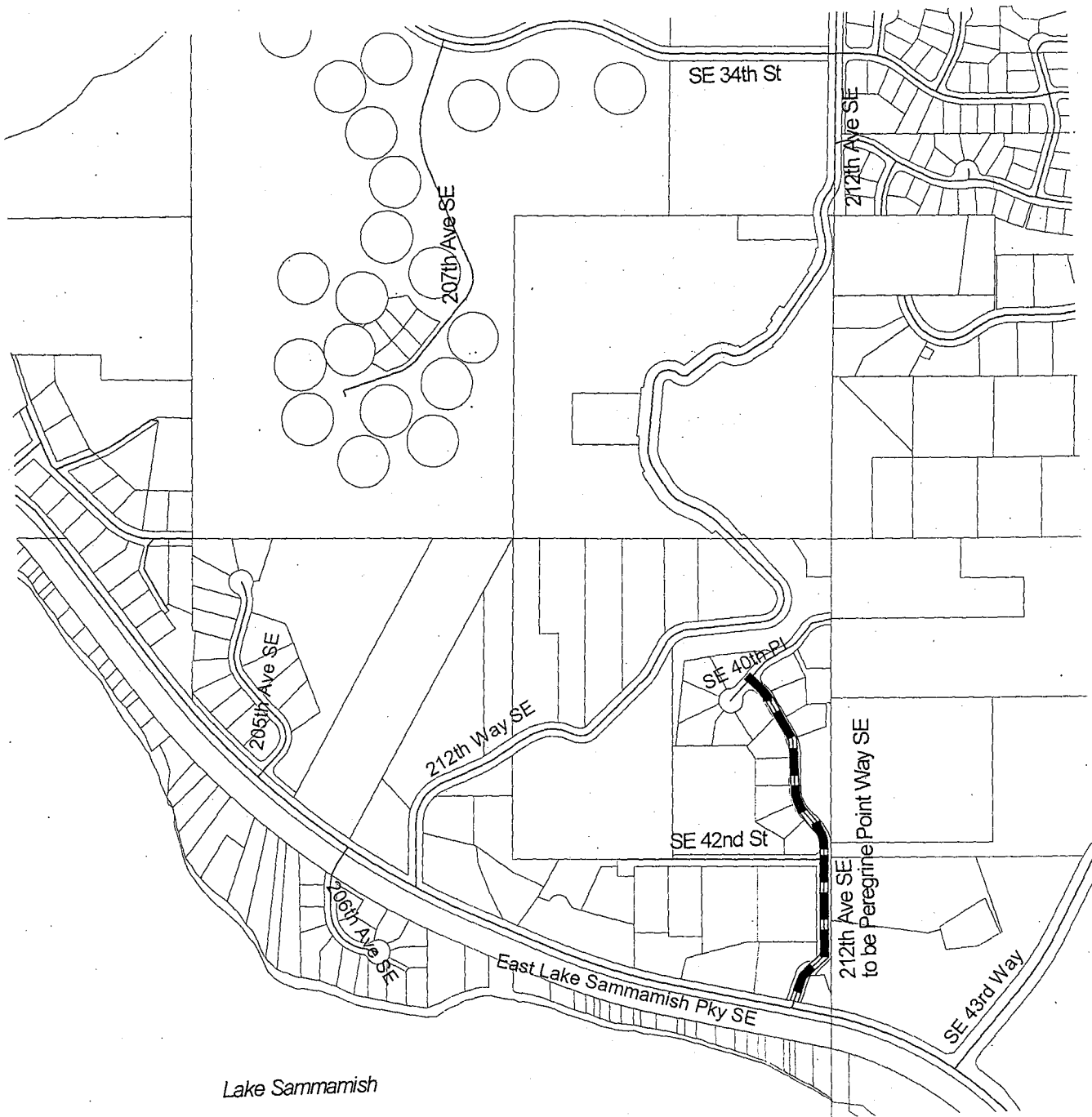

500 0 500 Feet



KC DDES jking 6/30/97

This map is not guaranteed to show accurate measurements.